



Pristine Solace

3
Bedrooms

2
Bathrooms

1,750
Living Area



Pristine Solace

Pristine Solace

Amenities

Pool/Jacuzzi

Event grounds

High Ceilings

Office

Crew Access

Video Walk-Through

Your ideal retreat for an exquisite LA-area adventure is waiting! Step into this recently renovated, impeccably furnished Woodland Hills home, and enjoy the peaceful seclusion while being just 30 minutes from the heart of LA. With sights like Escondido Canyon Park and the Blue Moon Dolphin Cruise to enjoy, and all of Los Angeles available for your exploration, you can go out and tour the area or stay in and savor the relaxation. Minutes away from Calabasas, Malibu, the heart of Topanga Canyon.

You can expect a high-end experience from the moment you arrive. The high-end landscaping will draw you to the front door, and you'll find an iPad with Smart Home controls at the entrance. Explore the fully loaded kitchen, and get cozy in front of the electric fireplace in the living room or gas fireplace in the dining area. Outdoors, you can prepare a tasty meal at the outdoor BBQ and dining area, and then relax with a cocktail in the hot tub.

Need to check in with your business while you're away? This home offers a fully loaded office with two computers, printer, shredder, and office supplies, along with a hidden bed to create another beautiful and comfortable place to sleep. Wi-Fi is 1000MB in the house and 500MB in the yard, so you can connect quickly and for free no matter where on the property you are.

Interior

Total bedrooms	3
Total bathrooms	2
Full bathrooms	2

Area & Lot

Living area	1,750sq.ft.
Total area	1,750sq.ft.
Neighborhood	The valley
Architecture styles	Contemporary

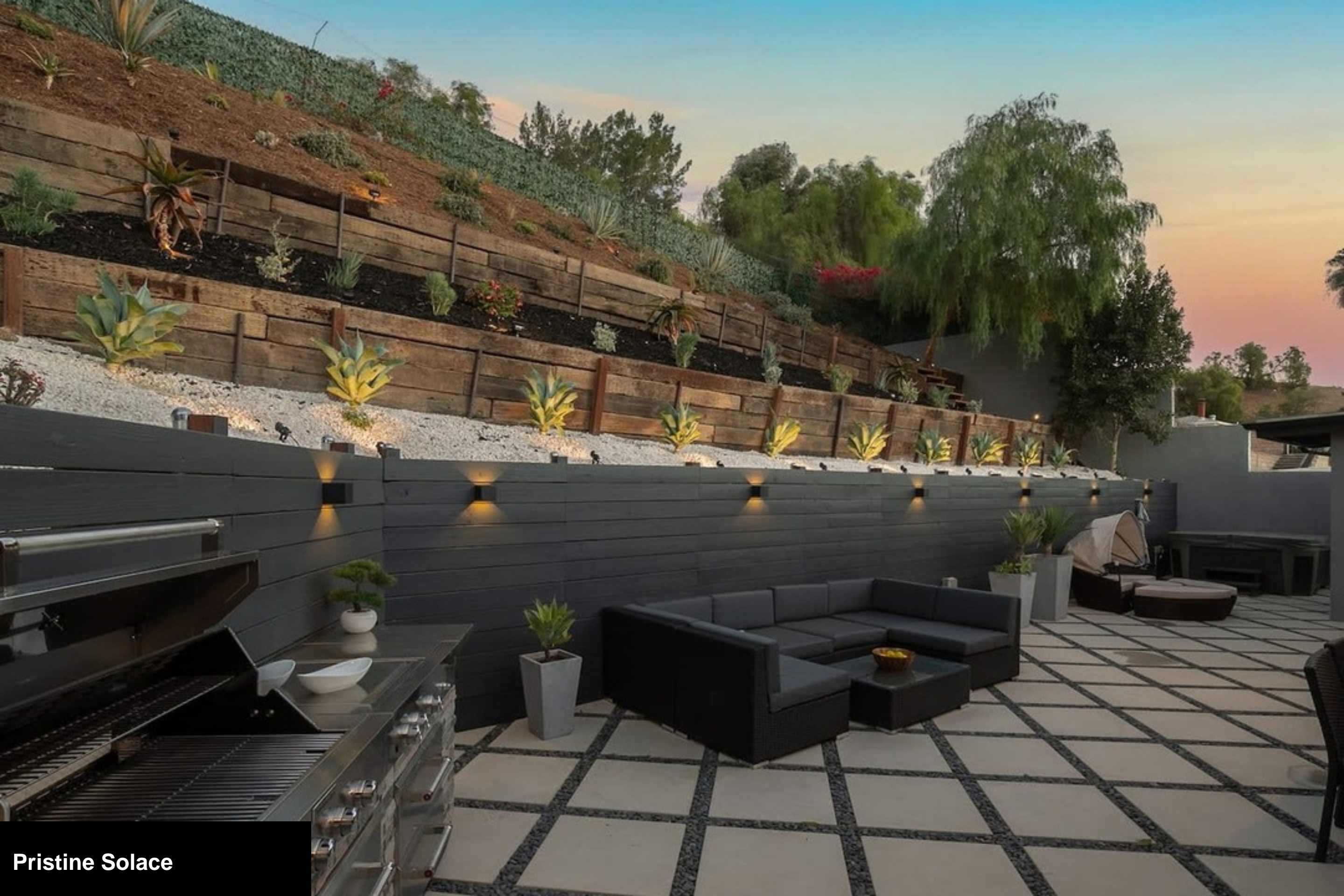

Pristine Solace



Pristine Solace





Pristine Solace





Pristine Solace









Pristine Solace



Pristine Solace







Pristine Solace







YOU NEVER KNOW
WHAT YOU HAVE
UNTIL IT'S GONE.
TOILET PAPER,
FOR INSTANCE.







Pristine Solace



